

# Advantenna-SP12™

## High gain RFID UHF antenna

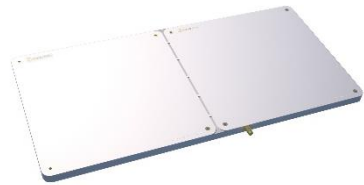

### Benefits:

- High gain
- Very thin form factor (compared to other high gain antennas available in the market)
- Very light weight
- Cost effective

### Applications:

- RFID portals
- RFID tunnels
- Tracking systems

### Product overview

Advantenna-SP12 is an ultra-light RFID UHF Antenna with a very high gain, circular polarization and a radiation pattern characterized by a 70° beam width in one plane and a 40° beam in the other plane.

The combination of a high gain, thin form factor and ultra-light design make this antenna ideal for many RFID applications such as RFID portals, RFID tunnels, tracking systems, etc.

### Specifications

Operating Frequency ETSI Version	865 - 868 MHz (ETSI EN 302 208)
Operating Frequency FCC Version	902,0 MHz - 928,0 Mhz
Operating Detection distance	Up to 10 metres
Gain	9.5 dBi (6.6 dBiL) EU version
Beam width	40° / 70°
Polarization	Circular
Input Impedance	50 Ω
Connector	PCB mount right angle SMA Beneath the bottom layer of the antenna, or between the layers of the antenna
Size excluding connector	417 mm x 207 mm x 11.6 mm 16. inches x 8.15 inches x 0.45 inches
Antenna weight	385 g

### Radiation pattern

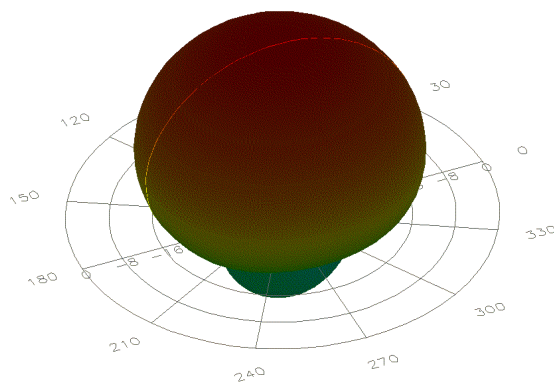

# Advantenna-SP12™

## High gain RFID UHF antenna



**Mechanical specifications:** connector between the layers of the antenna

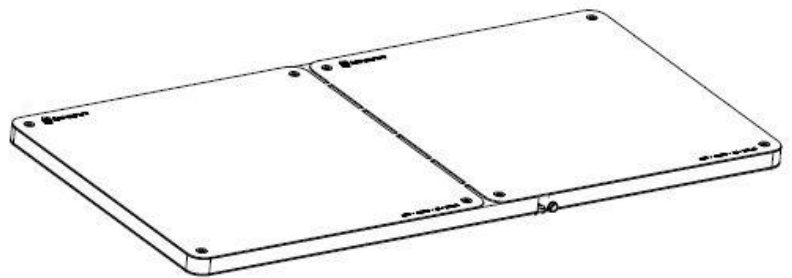
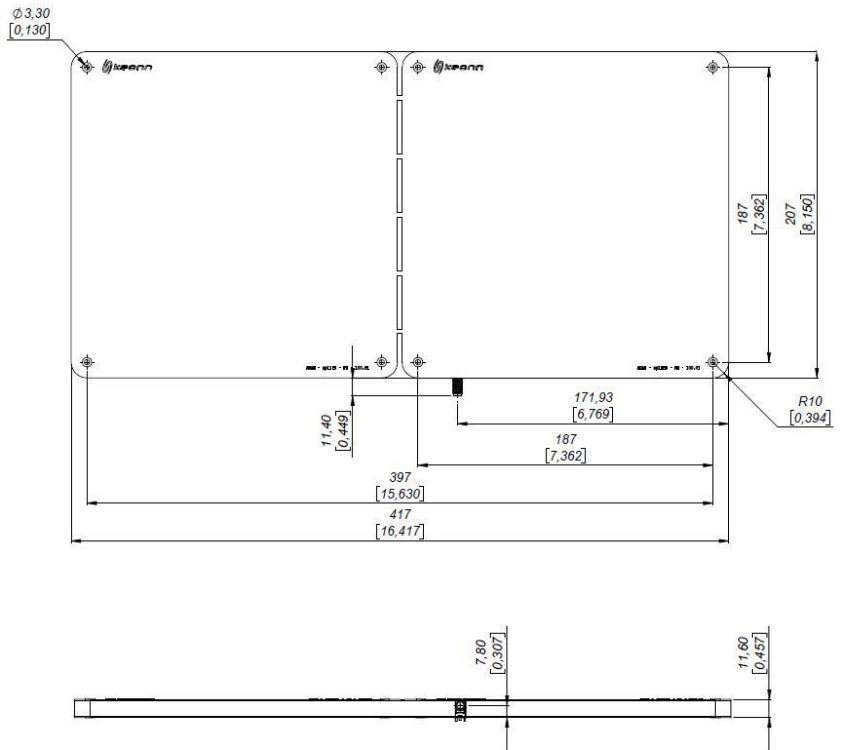

Units in millimeters  
[inches]

# Advantenna-SP12™

## High gain RFID UHF antenna



**Mechanical specifications:** connector beneath the bottom layer of the antenna

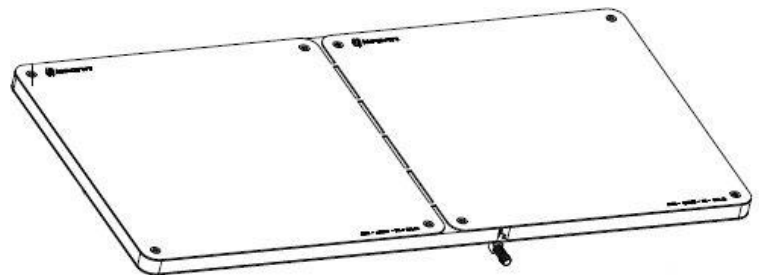
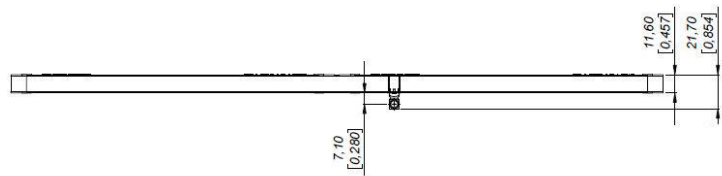
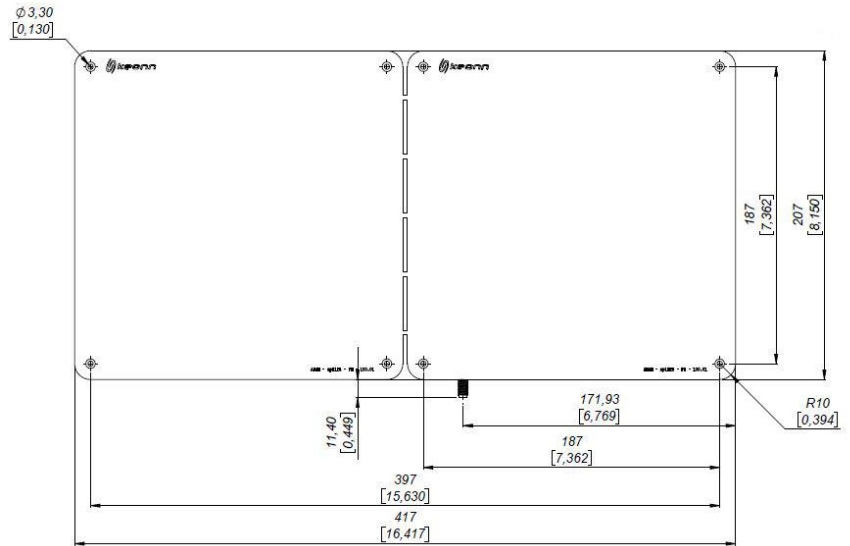

Units in millimeters  
[inches]

# Advantenna-SP12™

## High gain RFID UHF antenna

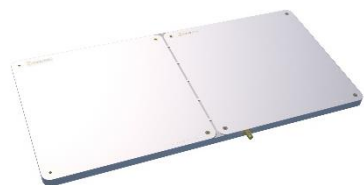

### Product codes for ordering

ADAN-SP12	FF	-	CS	CT	-	N	-	mmm	
									<b>FF = frequency band</b>
	EU								865,6 MHz - 867,6 MHz
	US								902,0 MHz - 928,0 Mhz
									<b>Connector shape</b>
			PRM						PCB mount right angle SMA connector between the layers of the antenna
			PRO						PCB mount right angle SMA connector beneath the bottom layer of the antenna
									<b>Connector type</b>
				SMA					SMA connector
									<b>Number of antennas in one board</b>
						1			Number of antennas
									<b>Model</b>
								100	Model number

\*to be released

Example:

- **ADAN-SP12EU-PRMSMA-1-100:**
  - Advantenna-**SP12**
  - European frequency band, 865,6 MHz - 867,6 MHz
  - **PCB mount right angle SMA connector** between the layers of the antenna
  - **One** single antenna
  - Model **100**